

SGL-1S1500: Hidden Drawer Cabinet Lock

Technical Informations

Administrator Card	2
User Card	12
Working Temperature	-25°C ~+55°C
Working Humidity	%5 ~%97
Usable Battery	4 Adet AA
Battery Life	Ortalama 1 Yil
Low Battery Threshold	2,4V
Very Low Batt. Threshold	2,2V



Introduction

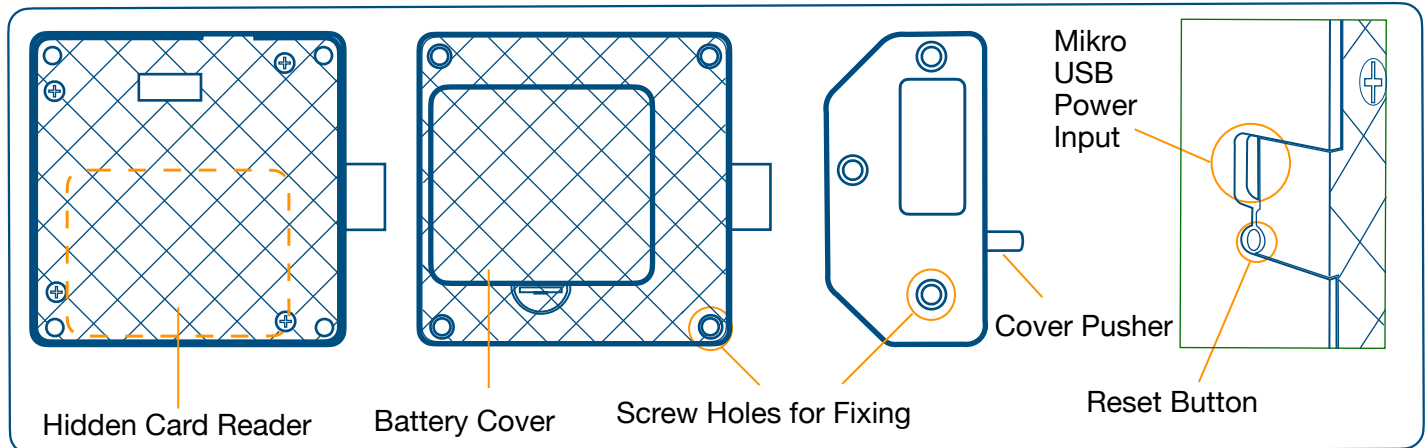

Installation

Things to consider before installation

1) Before mounting the lock, install the battery paying attention to the + and - poles.

⚠ Incorrect installation of the batteries can damage the circuit board.

2) Be sure to try the normal unlocking and locking of the lock before screwing in place to make sure the battery is properly installed. Do not forget to close the battery cover.

1. Card Categories

1.1. 2 Different categories of cards can be used in the Hidden Drawer Cabinet Lock.

- Administrator Card (2 Cards can be set)
- User Card (Up to 12 cards can be set)

1.2. An administrator card is used to add user cards to their card.

⚠ If you have installed the lock, set the administrator card (s) while the drawer or cabinet door is open.

2. First Setup:

2.1. **Initialize:** Press and hold the reset button on the side of the lock for about 3 seconds. It makes a long beep. From this moment on, all card information in the lock's memory is deleted, if any..

2.2. Introducing the Administrator Card

2.2.1. If you will use a single administrator card; Have the card swipe. It will start to make a warning sound. Wait for the warning tone to stop.

2.2.2. If you will use double administrator cards; Have the administrator cards read one after the other. Wait for the warning tone to stop. The first 2 cards swiped are accepted as the administrator card.

ⓘ Administrator card can unlock in any mode.

2.3. **Adding a User Card:** After reading the administrator card, the door is unlocked and it starts to give an audible warning and continues for 10 seconds. User card can be added while the audible warning continues. While the beep continues, you can swipe the cards you want to introduce one after the other. After a while, the audible warning stops and automatically exits the card recognition mode. If the addition is successful, it will make a sound; Two sounds if the inserted card already exists, and four sounds when the card is full of memory.

3. Unlock Function:

3.1. Have the identified user card read into the lock. It will unlock, open the cover. It will automatically come to the locked position 5 seconds after unlocking. You can complete the locking by closing the cover.

4. Administrator Card Functions:

4.1. **Add User Cards:** Once you have the administrator card scanned, the lock will unlock and enter the lock user card add mode.

4.2. **Delete User Cards:** Yönetici kartın arka arkaya üç kez okuttuktan sonra 5 saniye bekleyin, tüm kullanıcı kartları silinecektir.

4.3. **Turn On / Off Unlocking Sound:** The lock comes from the factory to an unlock sound (Do-Re-Mi-Do-Re-Mi) after the card is scanned. You can turn this sound off if you want.

4.4. Wait 5 seconds after reading the administrator card. Have the administrator card scanned 3 more times in a row. It emits 3 beeps at the end of the warning period. A 3-time beep indicates that the unlock alert tone is turned off.

4.5. Do-Re-Mi-Do-Re-Mi will sound if you repeat the same process. In this case, you will hear this sound every time the lock is unlocked.

5. Deleting Cards and Restoring Factory Settings

5.1. Have the administrator card scanned 5 times in a row. You will hear a long sound. The key will delete all card information in it, including the administrator(s) card (s).

Or

5.2. If you press and hold the reset button on the side of the lock for more than 3 seconds, all card information will be deleted and the lock will return to factory settings.

6. Low Battery Warning:

6.1. The lock is unlocked after reading the card. You will hear a tone indicating insufficient energy on the battery. In this case, the door lock can be used about 20 times, We recommend replacing the batteries in time. If the lock detects very low voltage, it will not lock automatically. If it is de-energized while the lock is open, it will not be able to lock automatically. After replaced the batteries it will not lock automatically after energized. If you scan the administrator card or user card, it will wait open and automatically lock after 5 seconds.

7. Dimensions

